

Stop guide

Next services information

Visit transportnsw.info or scan this QR code for next services information



Transport connections

L1 Dulwich Hill Line service frequency:
Monday to Friday:
 6am to 7am - 15 minutes
 7am to 10am - 8 minutes
 10am to 3pm - 10 minutes
 3pm to 7pm - 8 minutes
 7pm to 11pm (midnight on Friday) - 15 minutes
Saturday:
 6am to 9am - 15 minutes
 9am to 9pm - 10 minutes
 9pm to 11pm - 15 minutes
Sunday and Public Holidays:
 6am to 9am - 15 minutes
 9am to 7pm - 10 minutes
 7pm to 11pm - 15 minutes

B Bus services depart from: Bus stop 204054 towards Martin Place and Leichhardt Marketplace
 Bus stop 204083 towards Leichhardt Marketplace
 For more details and of services from other bus stops nearby visit transportnsw.info

Customer assistance

Emergency HELP Emergency Help Points link directly to staff who can assist you. Penalties may apply for misuse of Emergency Help Points.
T-Switch This stop is equipped with hearing loops and coverage areas are shown on the Stop map below. Use a T-Switch hearing aid to more easily hear customer announcements.

Lost items To report lost items visit transportnsw.info or call 02 8584 5288. Monday to Friday 09:00 to 17:00 (excluding public holidays). For hearing or speech impairments, please contact the National Relay Service on 133 677 or visit relayservice.gov.au

Tickets

For light rail services, you can use an Opal card, a contactless credit or debit card or a linked device to pay for travel by tapping on and tapping off at the Opal readers on each platform.
 Plan ahead and top up or purchase your Opal card online or from an Opal retailer. Visit transportnsw.info for more information.
Tap on and tap off, every time. Remember to both tap on and tap off to avoid a fine of up to \$550.00.

Destinations

1 War Memorial Park

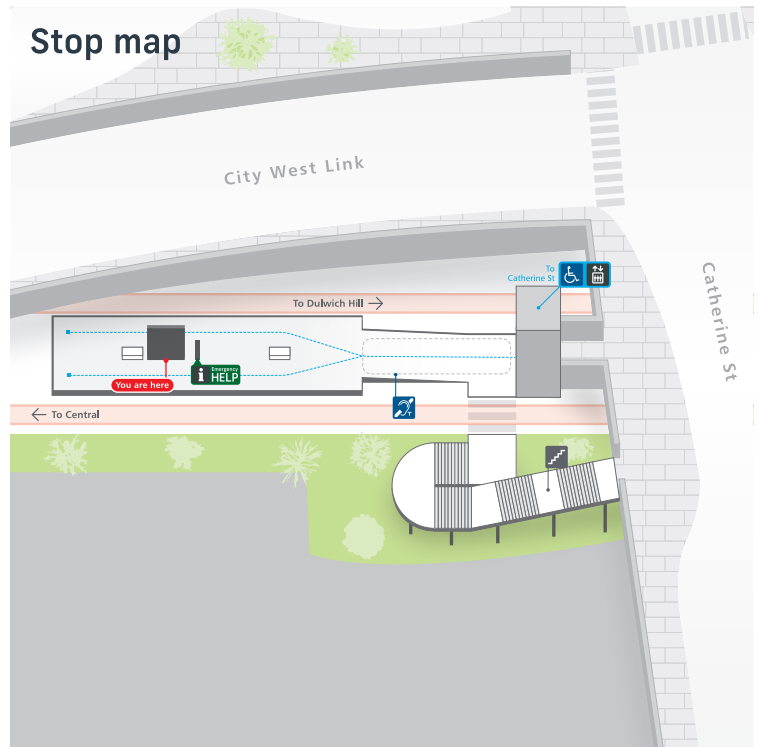

Sydney light rail network

L Light Rail

Sydney light rail lines

- L1** Dulwich Hill Line
Dulwich Hill
Central
- L2** Randwick Line
Circular Quay
Randwick
- L3** Kingsford Line
Circular Quay
Juniors Kingsford



Copyright © 2020 Transport for NSW